

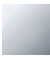



36 607 706

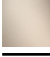

- rosace 60 x 60 mm
- avec marquage froid
- tête de commande avec broche et douille à sectionner

	Chrome	36 607 706-00
	Platine brossé	36 607 706-06
	Dark Chrome	36 607 706-19
	Champagne brossé (Or 22cts)	36 607 706-46
	Champagne (Or 22cts)	36 607 706-47
	Dark Platinum brossé	36 607 706-99

**Accessoires requis**



- Robinet à encastrer 1/2" -** 35 607 970 90
- profondeur de montage max. 150 mm
  - profondeur de montage mini. 105 mm

36 607 706

mm [inches]

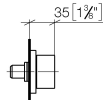
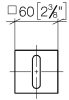

Certificats

DVGW\_DW-  
6501DN0116.

IAPMO\_4976 (1).

LGA\_29931.

WRAS\_2010066.

LGA\_29932.

36 607 706

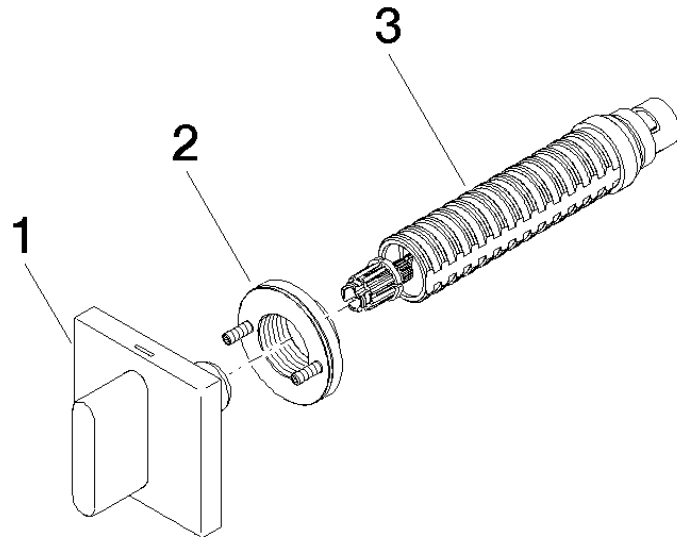

### Liste des pièces de rechange

N°	Article Numéro	Désignation	Fréquence de montage	Délai de livraison
1	90 20 70 051 02-00	poignée ( cold )	1	10
2	90 21 02 108 00 90	rondelle	1	2
3	90 90 03 143 00 90	tête céramique	1	2